



ROSEHILL CASTLE
Own Your Villa in Ranchi



**ROSEHILL
CASTLE**



**KONKI,
PITHORIYA**

Our Company

Woodberry Estate Private Ltd. is an initiative of a group of Professionals coming up with unique ideas to growing world of business.

Woodberry Estate Pvt. Ltd. has been design by its expertise in an unmatched medium with a unique construction model to set a new genera of development. The objective of the company is to provide construction, designing facilities and affirms lands or plots at the lowest of its cost as well.

The model is designing by keeping all odds and ends in context of the consumers who are about to be the extended family of the woodberry.



Our Visions & Missions



Visions- Our vision is to create an idea that the real Estate world is full possibilities to connect people not just on professional but also on personal ground. The company aspires to escalate the standard to real estate business in a cost effective way.

Mission - Our mission is to change the real estate portfolio by providing land along with better quality amenities without creating any hindrance in our costumers' bank balance.

ROSEHILL CASTLE Local advantages & Connectivity

Rosehill Castle in konki, Pithoriya; close to kanke, the fastest growing area in ranchi, Jharkhand. "Rosehill Castle" has a proximity to all basic amenities that are required for a standard lifestyle. "Rosehill Castle" is located within a distance of 20KM from the main city of Ranchi. It has proper accessibility to the leading school, colleges, hospitals, shopping corners and food outlets to enjoy the ease of living a better society.

Amenities

- | | | |
|-------------------------|-----------------------|--------------------------|
| ● 35 Ft. MAIN ROAD | ● SOCIETY GATE | ● SECURITY |
| ● 30 Ft. BRANCH ROAD | ● STREET LIGHT | ● LANDSCAPING |
| ● SOCIETY GATE | ● ELECTRIC POLE | ● CONSTRUCTION SUPPORT |
| ● SWIMMING POOL | ● BANQUET HALL | ● FREE HOUSE LAYOUT PLAN |
| ● MINI GOLF COURT | ● SNOOKER CLUB | ● E.M.I OPTION |
| ● CRICKET/FOOTBALL TURF | ● GYM/HEALTH ACTIVITY | ● 0% INTEREST |
| ● BASKET BALL COURT | ● FOUNTAIN | ● RESTAURANT |
| ● VOLLEY BALL COURT | ● SHOOTING PRACTICE | ● PARK |

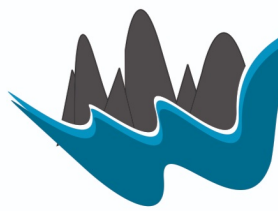

ROSEHILL CASTLE

Own Your Villa in Ranchi

Ranchi's First Resort-Style Farmhouse Society

Location: Konki, Pithoriya | Project by Woodberry Estate.

A Unique Investment, A Lifetime of Returns

Rosehill Castle is not just about owning land or a villa; it is about owning a lifestyle. This exclusive farmhouse society in Ranchi is designed to give you a perfect blend of luxury, recreation, and future value growth.

With thoughtfully planned infrastructure and world-class amenities, every rupee you invest here works harder for you—bringing back both joyful experiences and solid financial returns



Why Invest in Rosehill Castle?

- **High ROI Potential** – With its prime location and unmatched facilities, property value here is bound to appreciate faster than traditional plots.
- **Resort-Style Living** – Enjoy leisure, sports, fitness, and nature—right outside your door.
- **Community with Class** – Designed as a secure, modern society that promotes premium lifestyle and peaceful living.
- **Support & Ease** – From construction support to EMI options and 0% interest plans, owning your dream villa has never been this easy.
- **Banquet & Restaurant Advantage** – Drive additional value as demand for events & dining grows.

Your Villa. Your Resort. Your Future.

Exclusive Amenities That Add Value to Your Investment

- **Wide Roads** – 35 ft Main Road & 30 ft Branch Roads ensure smooth access and connectivity.
- **Swimming Pool** – Luxury leisure right at your doorstep.



- **Cricket Turf** – A dedicated space for sports lovers.



- **Mini Golf & Volleyball Courts** – Unique recreational experiences within your society.

- **Gym & Fitness Facilities** – Your health is our priority.



- **Badminton & Basketball Courts** – Stay fit and active with modern sports facilities.



- **Billiards & Snooker Arena** – Indoor luxury gaming for evenings and weekends.

- **EMI Options & 0% Interest** – Easy ownership, zero stress.

- **Society Gate & Security** – A fully secured gated community for peace of mind.



- **Shooting Zone** – Unique adventure & leisure experience.



- **Electric Poles & Street Lights** – Ensuring 24/7 safety and convenience.

- **Water Fountain & Landscaping** – Aesthetic beauty and serene environment.



- **Construction Support & Free Layout Plan** – We help you build your dream home hassle-free.



- **Banquet Hall** – Celebrate life's biggest moments within your community.



- **Restaurant** – Fine dining, just steps away from your villa.



Villa Cum Resort Layout & Landscaping

Villa Layout



30*40 sq.ft



35*35 sq.ft



30*40 sq.ft



35*35 sq.ft

Landscaping



13 Dis Plot Size



10 Dis Plot Size



15 Dis Plot Size

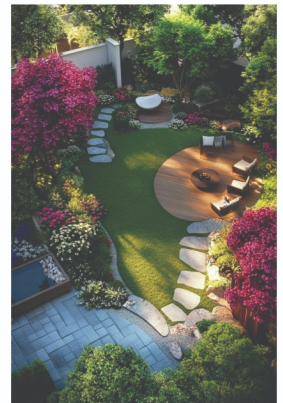

12 Dis Plot Size

Backyard Garden



15 Dis Plot



12 Dis Plot



10 Dis Plot

Bamboo House



Bamboo Backyard

Konki Chowk

PITHORIYA - THAKURGAON - KHELARI HIGHWAY



PUSU-VILLAGE ROAD

A
B
C
D
E
F
G
H
I
J
K
L

1 2 3 4 5 6 7
Project Expansion

9 10 11 12 13
Project Expansion

Project Expansion

Project Expansion

PLOT	NAME	COLOR	INDEX	SIZE
	RANDOM		Ra	RANDOM
	RANDOM UPPER		Ru	RANDOM
	RANDOM PARK		Rp	RANDOM
	RANDOM LEFT		Rl	RANDOM
	RANDOM RIGHT		Rr	RANDOM
	RANDOM DOWN		Rd	RANDOM
	VIOLET PLOT		Vp	12.05 Dis
	GOLF PLOT		Gp	22000sq.ft
	BANQUET PLOT		Bq	RANDOM
	Purple PLOT		Rd5	12.81 Dis
	RED PLOT		Rep	12.90 Dis
	Orange PLOT		Orp	14.42 Dis

PLOT	NAME	COLOR	INDEX	SIZE
	A TO L		A1 to L13	12 Dis
	A TO L		A1 to L13	15 Dis
	BROWN PLOT		Br	10 Dis
	MINI GOLF		MINI GOLF	22000sq.ft
	CRICKET		CRICKET	11000sq.ft
	SWIMMING POOL		POOL	2000sq.ft
	BANQUET RESTAURANT		Ban RESTAURANT	1Acre+

VILLAGE ROAD

FUN PARK COMING SOON

FUTURE PLAN

News Update & Upcoming Projects

jagran.com/jharkhand/ranchi-foundation-stone-of-rims-2-will-be-laid-in-15-days-hemant-soren-inspected-the-site-k

Jharkhand News: RIMS-2 का शिलान्यास कब होगा? स्वास्थ्य मंत्री ने दे दी जानकारी; इस जगह होने जा रहा निर्माण

रांची में राजेंद्र आयुर्विज्ञान संस्थान (रिम्स) की तर्ज पर रिम्स-टू का निर्माण होगा। इसके लिए कांके के रिन्पास परिसर में 110 एकड़ जमीन चिह्नित की गई है। स्वास्थ्य मंत्री ने बताया कि मुख्यमंत्री 15 दिनों में इसका शिलान्यास करेंगे। यह मेडिकल कॉलेज 1074 करोड़ रुपये की लागत से बनेगा। इस अस्पताल के बनने से लोगों की सुविधाएं और अधिक बढ़ जाएंगी।

BY NEERAJ AMBASTHA
EDITED BY: SANJEEV KUMAR
UPDATED: WED, 22 JAN 2025 12:49 PM (IST)

आउटर रिंग रोड के तीन फेज का सर्वे पूरा

विशेष संवाददाता, रांची

इस साल शुरू होना है काम

□ केंद्रीय मंत्री निहित गडकरी की घोषणा के बाद कार्य में तेजी आयी है □ आउटर रिंग रोड की लंबाई करीब 194 किमी होगी

रांची के आउटर रिंग रोड के तीन फेज का सर्वे हो गया है। अन्य चरणों का सर्वे हो रहा है। सर्वे करा कर रिपोर्ट केंद्रीय सड़क, परिवहन और राजमार्ग मंत्रालय को भेजी जायेगी। वहां से इसकी स्वीकृति मिलने के बाद इस पर काम शुरू होगा। यह अनुमान लगाया जा रहा है कि इस साल सारी प्रक्रिया करने के बाद आउटर रिंग रोड पर काम शुरू



नेशनल हाइवे 75 के मोड़र के पास

रांची में ट्रांसपोर्ट नगर का किया जा रहा है निर्माण रांची, पीएम गति शक्ति योजना के तहत झारखंड में कुल 169.71 करोड़ की लागत से तीन परियोजनाओं पर काम चल रहा है। इसमें रिम्स में लॉजिस्टिक्स पार्क, रांची में ट्रांसपोर्ट नगर व ओरमांडी के कुल्ही में स्टेट हाइवे का निर्माण हो रहा है। यह जानकारी वाराणसी में आयोजित पीएम गति शक्ति योजना की पांचवीं क्षेत्रीय कार्यशाला की बैठक में उद्योग विभाग के विशेष सचिव प्रणव पाल ने दी। कार्यशाला में उन्होंने कहा कि पीएम गति शक्ति योजना के मास्टर प्लान के अनुसार ही झारखंड ने भी मास्टर प्लान तैयार किया है। करीब 50 प्रखर के डाटा को जीआइएस से टैग किया गया है। इसमें तमाम

Edition  IN

English

 Ranchi  27°C

THE TIMES OF INDIA

New
TOI Games Live Videos City India World Business Tech Cricket Sports Entertainment Astro TV ...

News / Rims-2 Project On Amid Dialogues

Rims-2 project on amid dialogues

May 26, 2025, 22:16 IST

 Share  AA  Follow Us



Ranchi: The construction of boundary wall for the second campus of the Rajendra Institute of Medical Sciences (Rim-2) on the Kanke-Patratu Road has begun, officials said.

Three triple-layer barricades have been set up on the approach road to control protests and prevent disruption to the demarcation process. Additionally, a 24-

R.I.M.S 2,Outer Ring Rd,Transport City,
Bharat Mala Rd and many more.

ws/jharkhand/ranchi-nitin-gadkari-approves-ranchi-outer-ring-road-project-cost-6000-crore-ws-l-936

देश क्रिकेट दुनिया मनोरंजन मनी लाइफ़ प्रदेश नॉलेज करियर वीडियो

रिंग रोड का सपना होगा सच, मिली केंद्रीय मंत्री नितिन जूरी, 6000 करोड़ होगी लागत

25, 22:02 IST

ad project: रांची में नितिन गडकरी ने कई योजनाओं का उद्घाटन किया और आउटर रिंग रोड के DPR



NEWS 18
हिंदी

होम देश क्रिकेट दुनिया मनोरंजन मनी लाइफ़ प्रदेश नॉलेज करियर वीडियो धर्म

रांची आउटर रिंग रोड का सपना होगा सच, मिली केंद्रीय मंत्री नितिन गडकरी की मंजूरी, 6000 करोड़ होगी लागत

Edited by: **Rajneesh Singh**

Last Updated: July 03, 2025, 22:02 IST

Ranchi outer ring road project: रांची में नितिन गडकरी ने कई योजनाओं का उद्घाटन किया और आउटर रिंग रोड के DPR को मंजूरी दी. 6,000 करोड़ की लागत से बनने वाली यह रोड रांची को सात जिलों से जोड़ेगी और ट्रैफिक कम करेगा... **और पढ़ें**



इम्पैक्ट शॉर्ट्स
सबसे बड़ी खबरों तक पहुंचने का आपका शॉर्टकट



न्यूज़ बुलेटिन



गूगल न्यूज़ पर हमें फॉलो करें



रांची: केंद्रीय सड़क परिवहन और राजमार्ग मंत्री नितिन गडकरी ने आज झारखंड पहुंचकर कई योजनाओं का उद्घाटन किया. इस दौरान उन्होंने कई फ्लाईओवर और राष्ट्रीय राजमार्ग परियोजनाओं का लोकार्पण और शिलान्यास किया. झारखंड की राजधानी रांची में आउटर रिंग रोड के निर्माण की मांग लंबे समय से की जा रही है. गडकरी के रांची पहुंचने पर एक बार फिर रांची में आउटर रिंग रोड के निर्माण की मांग उठी. केंद्रीय

LOCATION MAP

ALBERT EKKA CHOWK (RANCHI)

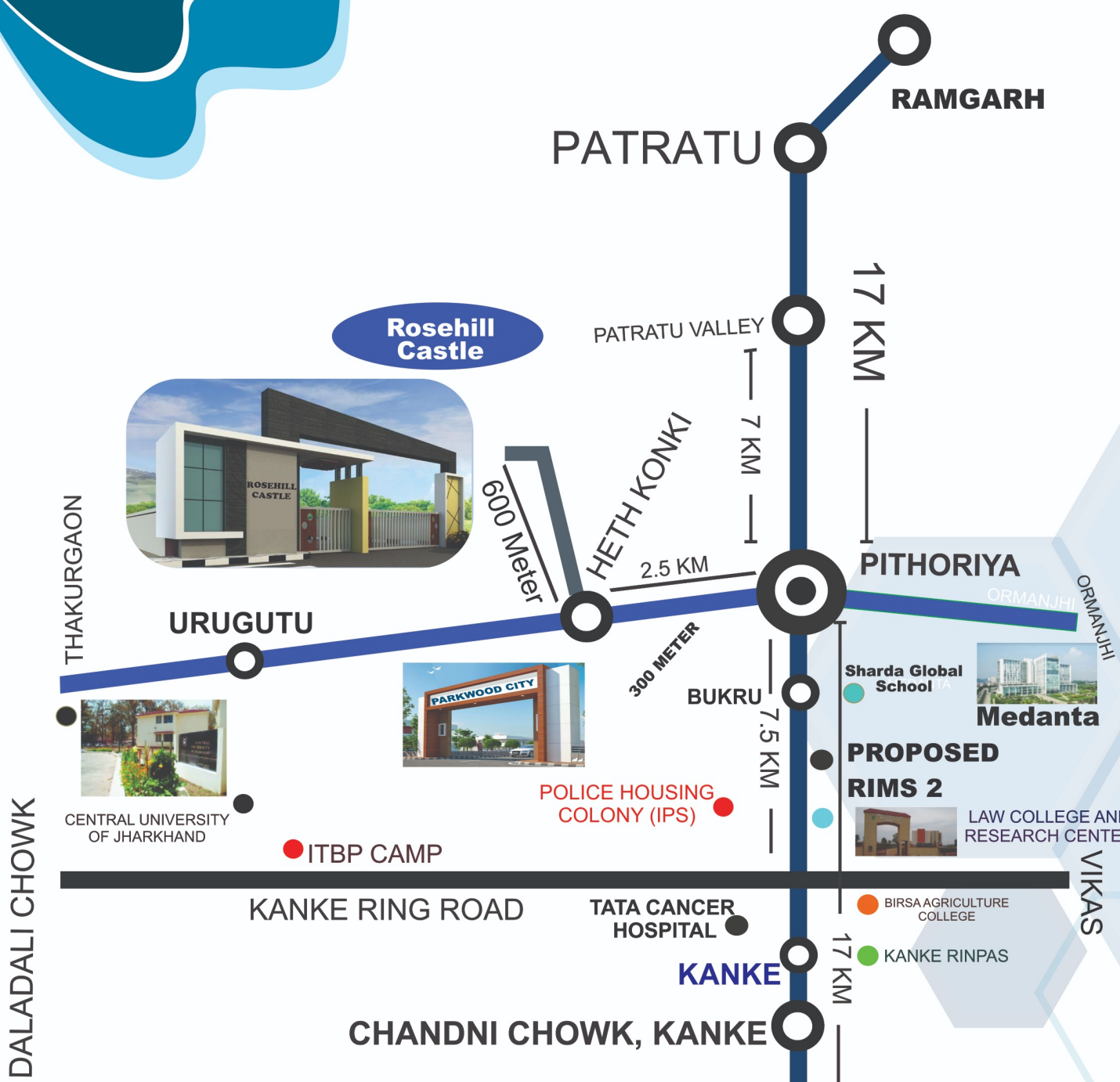

Scan For Direction

Our Other Services

Interior designing-

We work on providing a modern look to the existing as well as new interiors of living/office space. We transform an old interior into a fresh looking area according to the requirements, which includes appropriate colours/ paint to the walls and ceiling designer lights/bulb and false ceiling to make the space look attractive.

Wall Texture-

We provide our services to give furnished texture to flat/ uneven walls. We add interest to the plain and simple walls with the help of new/contrast colours and trending wall designs according to the preference/requirement.

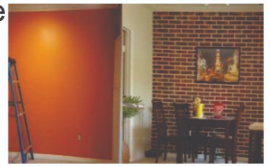

Gardens-

We transform land/ground into a beautiful lawn which comprises a garden, small pond and a sitting area which gives a nature friendly look to the residence.

We extend our services to create balcony/ terrace gardens.



Modular Kitchen-

We facilitate the creation of trending modular kitchens where we give a designed look to the cooking space by providing a separate storage area and accommodate an open layout for cooking. We take proper care of the designs and look of the modular kitchen at pocket-friendly expenses.



Wardrobe-

We transform plain walls and shelves into wardrobe with the help of designer frames, sliders and glass for contemporary look.



Designing-

We create and provide house maps for construction. We design plots keeping in mind the proper entrance of the sunlight in a room, balcony and other needs. We design in 2D and 3D as well.

We also do landscaping for the construction plot by combining nature and contemporary culture. This includes aesthetic, building of garden, parking area, site drainage, groundwater recharge and other measurable consideration.



ROSEHILL CASTLE



OFFICE- 1st Floor Mubarak Apartment
Opp- Union Bank, Kantatoli, Ranchi-1



+91-9878366944,+91-7488673399
+91-7079491432,+91-9386219054



help@gowoodberry.com



www.gowoodberry.com



Scan For Office
Direction

